

# Yeosu Web Contents

2024년 05월 23일 02시 41분



# 목차

|   |   |
|---|---|
| 목차  | 2 |
| Yeosu Newspaper   | 3 |
| Creation of Eight Neighborhood·Culture Parks in a Disused Railroad Yard by 2023 | 3 |

## Creation of Eight Neighborhood·Culture Parks in a Disused Railroad Yard by 2023

2016.09.01 16:23 Views 501 Registrar 관리자

Project of creating park in Jeolla line disused railroad yard is creating a premium park which is a differentiated wellbeing/culture/rest place in the disused railroad yard that has been generated due to route alteration caused by operation of KTX.

The city will create six neighboring parks and two culture parks in the disused railroad yard with total length of 21.4km and area of 552,280㎡ by 2023.

The subject of the project in first stage which is aimed to be completed by next year is as follows: Seonwontteurae Park (Yeocheon Station), Wonhakdong Park (Hakdong), Mipyong Park (Mipyong), Orim Tunnel Park (Manheung), and Manheung Park (Manheung). And the one of the project in second stage is Yulchon Park (Yulcho Station), Daepo Park (Sora) and Yangjibareum Park (Deokyang Station). Their construction will start in 2018 and the completion goal is 2023.

As main facilities of those parks, trail, bicycle road, and performance hall will be installed and theme parks connected with local companies are also being reviewed for creation.

This project of creating park in disused railroad yard will provide a pleasant rest place which is loved by citizens by creating a differentiated health·leisure space where there are abundant nature and green areas.



(<http://www.yeosu.go.kr>)

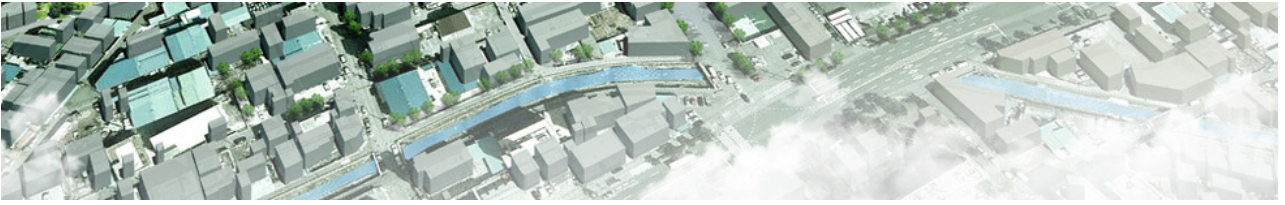

Attached File

Full

download(Zip)

 미평공원.jpg (145 hit/ 488.0 KB) ↓

[미리보기](#)

List

previous

Gyeongdo, Yeosu, Invests KRW 1.1 trill...

next

Geomundo and Baekdo Island Silver S...

COPYRIGHT © NAJU-SI. ALL RIGHTS RESERVED.

# Yeosu Web Contents

